

24441130	<b>DATA SHEET</b>	
Valid from: 10.11.2023	<b>EPIC® POWER M23 D6 HOUSING, SCREW</b>	

## Description

- Circular connectors for servomotors and power supply
- High power at smallest installation space
- Optimal solution for electric motors
- EMC-optimised design
- Safety use in field environment by high protection class
- Cable clamp for EPIC® POWER M23
- With seal
- With Cap Nut



## General characteristics

Series	EPIC® POWER M23 D6 housing type: screw, cable clamp, cap Nut
Version	Cable connector, package unit = 20 pcs
Temperature range	-25 to +125 °C
Degree of soiling	3

## Product Variations

Article number	Article	Cable clamping range in [mm]
24441133	EPIC POWER M23 D6 8,5-11 (20)	8,5 – 11
24441134	EPIC POWER M23 D6 10,5-15,5 (20)	10,5 – 15,5
381166119	EPIC POWER M23 D6 7.5-15,5 (20)	7,5-15,5
24441135	EPIC POWER M23 D6 14-17 (20)	14-17

## Materials and surfaces

Housing	Nickel-plated zinc die-casting
Coupling sleeve	Nickel-plated Copper Alloy
Clamping ring	Spring steel, coated
Cable clamp	PA
Seal	CRNBR
O-ring	FKM
Cap Nut	Nickel-plated Copper Alloy

Creator: STKU3/PDP Released: IVSE1/PDP	Document: DB24441130EN Version: 00	Page 1 of 3
---	---------------------------------------	-------------

24441130	<b>DATA SHEET</b>	
Valid from: 10.11.2023	<b>EPIC® POWER M23 D6 HOUSING, SCREW</b>	

Approvals

UL-File-Number

Approval in pending

Standard

Safety Standard

IEC 61984



Technical Drawing

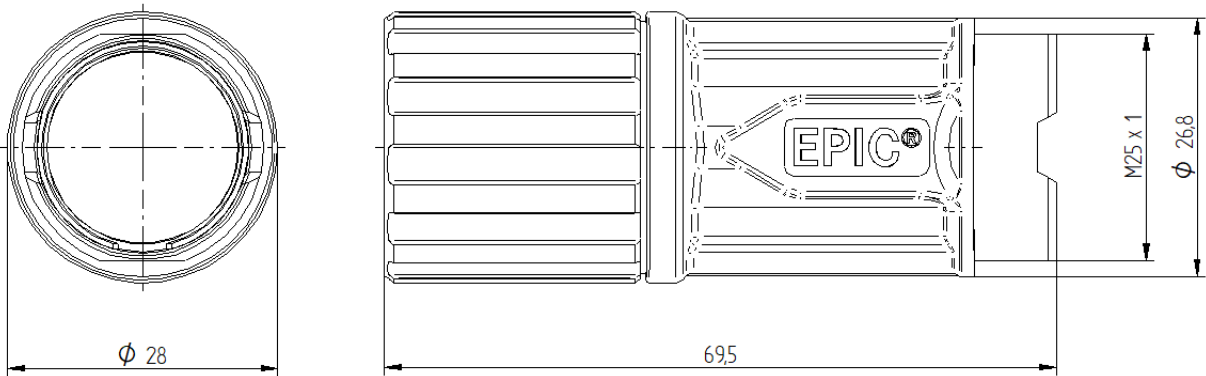

Item	Wrench size
housing	24
Cap nut	26 / 27 (14-17 & 7,5-15,5)

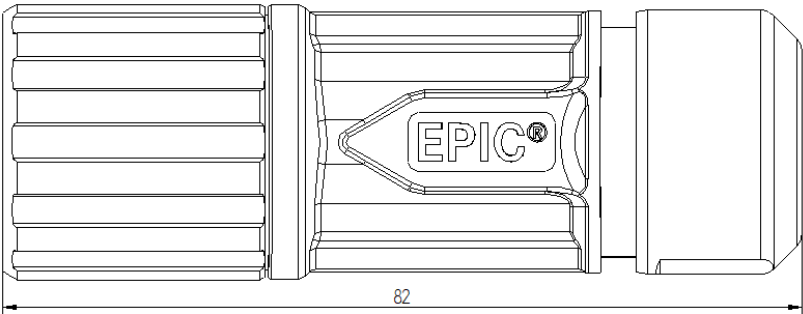

24441130	<b>DATA SHEET</b>	
Valid from: 10.11.2023	<b>EPIC® POWER M23 D6 HOUSING, SCREW</b>	



Good chemical resistance



Corrosion-resistant



Industrial machinery and plant engineering



Mechanical resistance

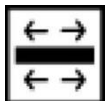

Optimum strain relief



Waterproof

### Application range

Plant engineering

Servo drives and servo assemblies

### Remark

Photographs are not to scale and do not represent detailed images of the respective products.

Creator: STKU3/PDP Released: IVSE1/PDP	Document: DB24441130EN Version: 00	Page 3 of 3
---	---------------------------------------	-------------